

AIRMAX

EcoSeries™ XL Debris Screen Installation Guide



I. ECOSERIES™ XL DEBRIS SCREEN REPLACEMENT PARTS

XL Debris Screen Replacement Parts

655193 - EcoSeries XL Debris Screen Assembly

1. 655197 – EcoSeries XL Debris Screen Bulkhead Kit
2. 655198 – EcoSeries XL Debris Screen Mounting Clamp Kit 4 Pk
3. 655199 – EcoSeries XL Debris Screen Hoop Clamp Kit 4 Pk

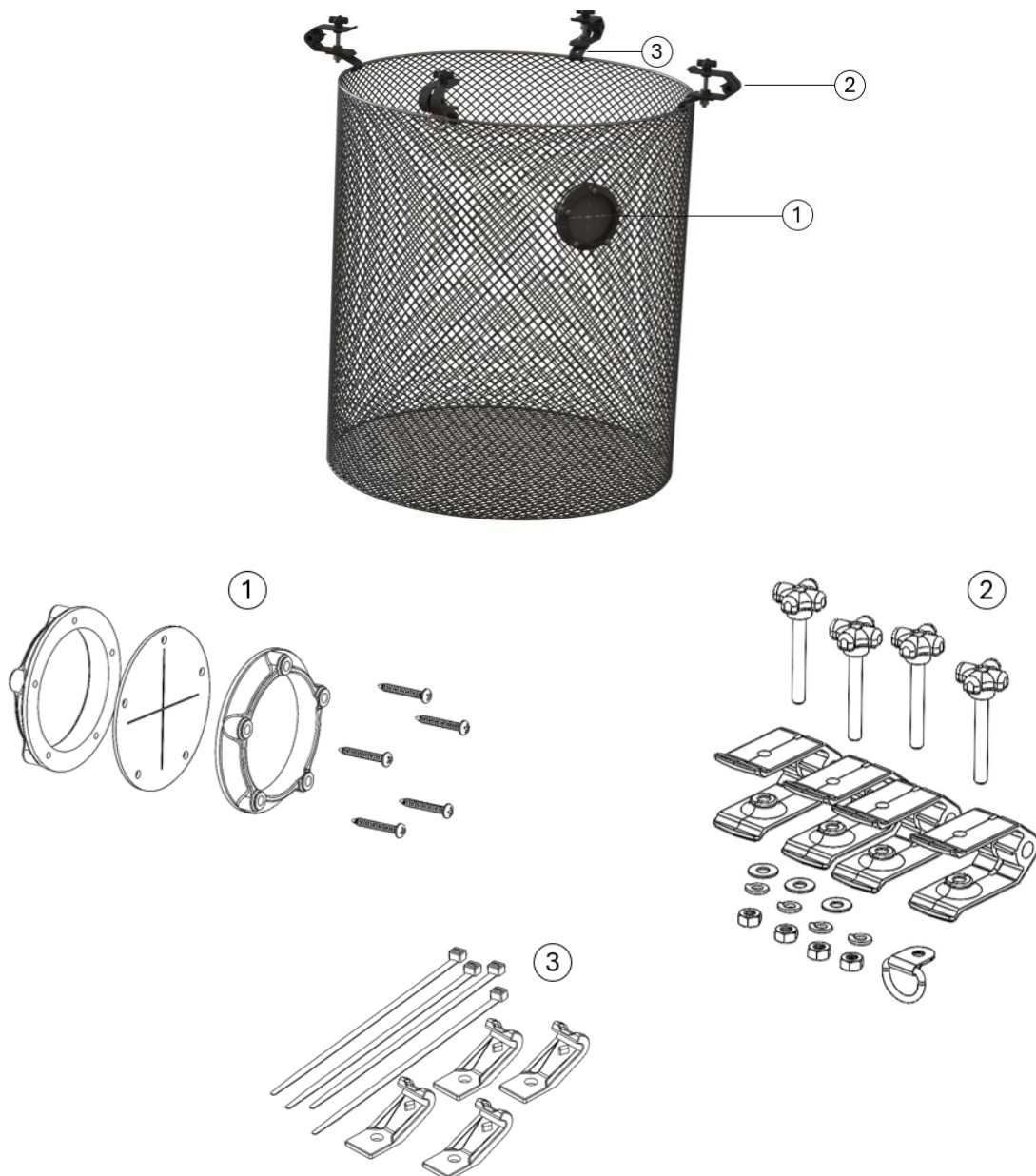

II. ECOSERIES™ XL DEBRIS SCREEN INSTALLATION

The EcoSeries XL Debris Screen is compatible with the 34" Airmax float; however, due to the depth of the screen, it is NOT compatible with the 1/2 HP PondSeries fountain.

PARTS INCLUDED

- EcoSeries XL Debris Screen
- EcoSeries XL Debris Screen Mounting Clamp Kit

TOOLS NEEDED

- 7/16" Wrench or Nut Driver
- 3/16" Allen Bit (optional)
- Light-Duty Cordless Drill (optional)

1. Lay the float on a flat surface with the Airmax logo facing up. Install the *Mounting Clamp Kit* by inserting the clamps on the inner mounting locations and securing with the thumb screws provided. The thumb screws can be tightened using a 3/16" Allen bit and a cordless drill, if desired. **NOTE: If using in conjunction with an Airmax RGBW Light Set attached at the inner mounting locations, simply leave the lights on the float, remove the existing thumb screws and install the longer thumb screws provided with the mounting clamp kit.**



2. Next, **flip** the float over so that the logo faces the work surface and the threaded side of the thumb screws are exposed. Set the debris screen on the float so that each hoop clamp seats over a thumb screw. **NOTE: Orient the screen on the float so that the bulk head is aligned closest to the Airmax logo on the opposite side.**

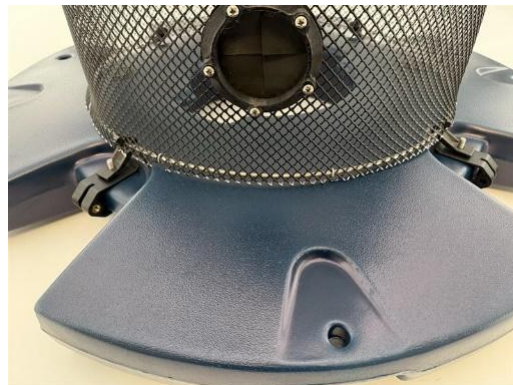

3. **Install** a tie-down ring, split-lock washer and nut on one of the hoop clamps nearest the bulkhead. This will provide an ideal strain relief location for motor and light set power cords. **Repeat** the process on the other three mounting clamps by installing a flat washer, split-lock washer and nut on each. Tighten using a 7/16" wrench or nut driver.

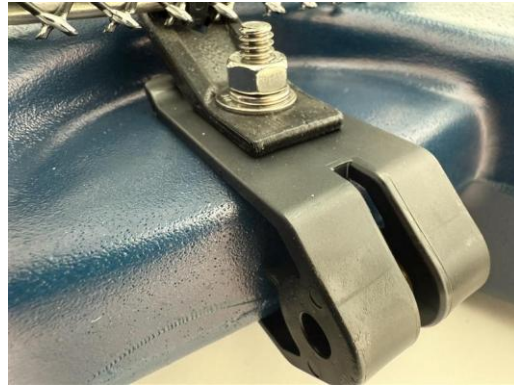

4. **Flip** the fountain and screen right-side-up OR lay the assembly it on its side. **Install** the fountain partway into the float from the top side, feeding the quick disconnect through the bulkhead, then seat the fountain all the way to the float mount ring.



5. **Connect** the power cord disconnect for the fountain (and optional light set) and secure each cord strain relief to the tie-down ring using a snap hook carabiner.
6. **Moor** the fountain in the water using either mooring stakes or cinder blocks.